

Section 2 – Control

Access: Press the OK button and keep pressed for 5 sec.

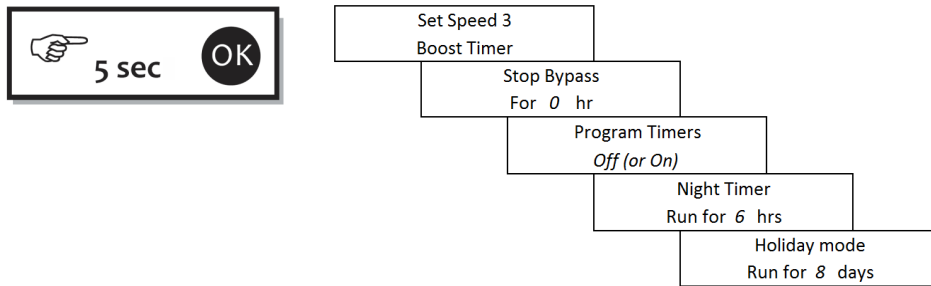

Fig. 2.4 Favourite User adjustments

NOTE!
The Night Timer can be adjusted 0 hour to 12 hours. Holiday mode can be adjusted 0 day to 30 days. When set, the unit will run at Speed 1 at all times. ("H" will show in the Display window)

NOTE!
Press the ◀ button for 1 second to return the display to normal.
(If no settings are made for 180 seconds, the display returns to the Standard display)

2.4 User menu

The user menu is used to program the weekly timer schedule, to set parameters and to view information about the status and operation of the ventilation unit.

Access: Press ◀ and OK buttons simultaneously and keep pressed for 5 sec.

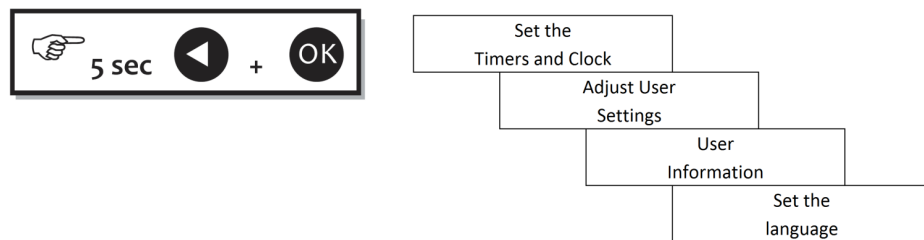

Fig. 2.5 User menu

NOTE!
Press the ◀ button for 1 second to return the display to normal.
(If no settings are made for 180 seconds, the display returns to the Standard display)

Section 5 – Maintenance

5.2 Cleaning the heat exchanger

WARNING!
Always isolate the unit from the power supply, before starting any cleaning!

Remove the front cover to the unit for access to the heat exchanger.

The plastic heat exchanger of the unit can be cleaned using clear water.
Cleaning should be carried out by a qualified technician.

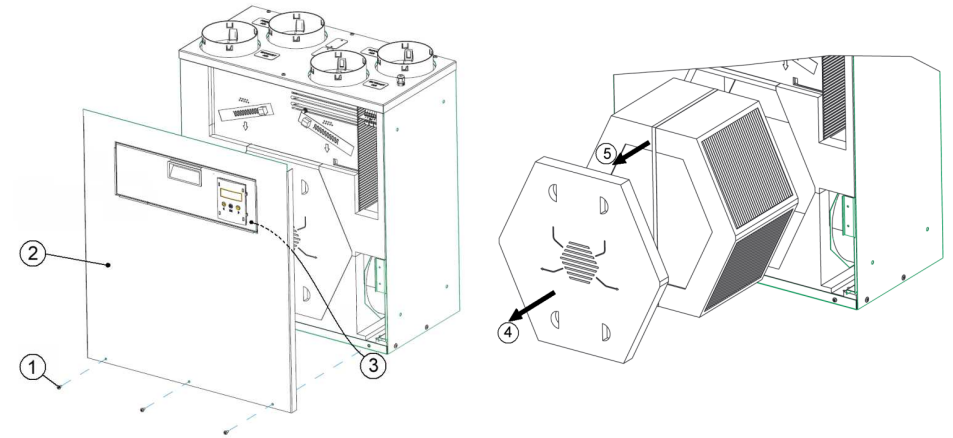

Fig. 5.2a Access to the Heat Exchanger

Fig. 5.2b Removing the Heat Exchanger

- Disconnect the unit from the power and remove the front cover screws (1) and then the front cover (2).
- Carefully remove the umbilical connector (3) from the back of the Display PCB.
- Pull out the EPP cover (4) and then remove the heat exchanger using the pull strap (5).
- Flush with lukewarm water (do not use cleaners), allow the water to drip off and insert it again.
- Replace the EPP cover, secure the umbilical connector and re-fix the front cover.
- Switch on the power.

NOTE!
When cleaning the heat exchanger, do not use a high-pressure cleaner and do not use any detergents or cleaning agents!

5.3 Cleaning the ventilation unit

The unit can be cleaned on the outside and, after removal of the heat exchanger (see above), also on the inside using a damp cloth.

Cleaning on the inside should be carried out by a qualified technician.

WARNING!
Always isolate the unit from the power supply, before starting any cleaning!

Section 5 – Maintenance

5 Maintenance

The ventilation unit must be maintained regularly to ensure good air quality and energy efficiency.



WARNING!

Always disconnect the unit from the power supply before starting any maintenance work!

5.1 Filter maintenance

All air filters in the system must be maintained regularly to ensure good air quality and efficient operation.

The following maintenance intervals are recommended :

- Check filters at least every 6 months.
- Change filters if required.
- Change filters at least annually. See *Spare Parts for replacement filters*.

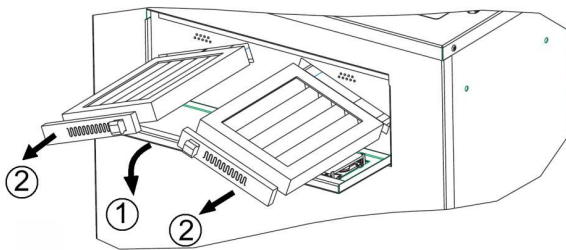

Fig. 5.1 Filter change

- 1 Open access door on front of unit
- 2 Pull out the filters, clean or change and replace



NOTE!

Note down the filter maintenance carried out (See Annex in User manual)

Maintenance of the fresh-air and exhaust-air filters can be carried out without the use of any tools.

Note down the date of the filter change.

Reset: After filter maintenance, reset the filter message and interval counter by selecting :

Filters changed “Yes” and pressing the OK button.



NOTE!

The unit must not be used without filters! (Without filters the unit performance will quickly degrade and the heat exchanger will “clog up”).

Use only original spares. Other filters and other grades can affect the proper functioning of the unit.

5.1.2 Maintenance of the external air-filter box (when fitted)

The ventilation unit is equipped with internal air filters.

An additional external air-filter box can be fitted to the duct work.

- To help protect the ventilation unit, a coarse pre filter box can be fitted to the Fresh air incoming duct.
- A pollen filter box, for allergy sufferers, can be fitted to the Supply air duct work.

The panel filters used in the external filter box must be maintained in the same way as the filters in the ventilation unit.

Section 2 – Control

2.4.1 Set the Timers and Clock : Use the ◀ and ▶ keys to select, then press OK

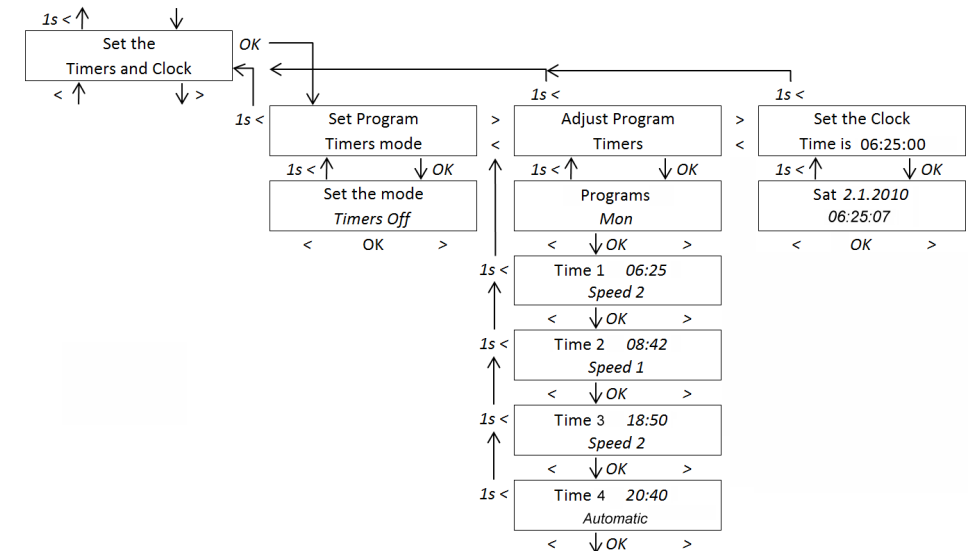

Fig. 2.6 User menu : Set the Timers and Clock

Option : “Set Program Timers mode” : Select then press OK

Set the mode : Press **OK** then ◀ or ▶ keys to select “Timers *Off*” or “Timers *On*”. Press **OK** to select the option required.

Press ◀ key for more than 1 second to move back up the menu.

Option : “Adjust Program Timers” : Select then press OK

Use the ◀ or ▶ keys to select the **Day** or **Set of days** in which a timer function is required.

For each Day or Days use the ◀ and ▶ buttons and **OK** to set the switching time and the operating mode.

- The timer uses a 24 hour clock display.
- The operating modes that can be chosen are :
 - Automatic** (This will return the unit to its normal Automatic mode)
 - Speed 1** (Use this speed for normal continuous ventilation)
 - Speed 2** (Use this speed to clear higher levels of humidity, such as from using a shower)
 - Speed 3** (Use this to provide a short time purge of the building)
 - Off** (Use this to switch the ventilation Off : Under normal circumstances Off should not be used)
 - None** (Use this if no change is required for a time slot)

Press ◀ key for more than 1 second to move back up the menu.



NOTE!

As a record, note the programmed switching times in the schedule table included in the annex.

Option : “Set the Clock” : Select then press OK

On the first line of the Display use the ◀ or ▶ and **OK** buttons to select the **Day** the **Month** and the **Year**. On the second line use the ◀ or ▶ and **OK** buttons to select the **Hour** the **Minutes** and the **Seconds**.

Press ◀ key for more than 1 second to move back up the menu.